



CONDENSATE EXTRACTION PUMP SEAL

SSCESB



MATERIALS

Hardware : 316 SS, Alloy C-276 & Alloy 20

Rotating face : SiC

Stationary face : Carbon, Antimony Carbon

Elastomers : FKM, FFKM

OPERATING CONDITIONS

Shaft : 120 - 200 mm

Pressure : 40 - 140 Bar Max.

Temperature * : -20 ~ 300 °C

Speed : Upto 6500 rpm

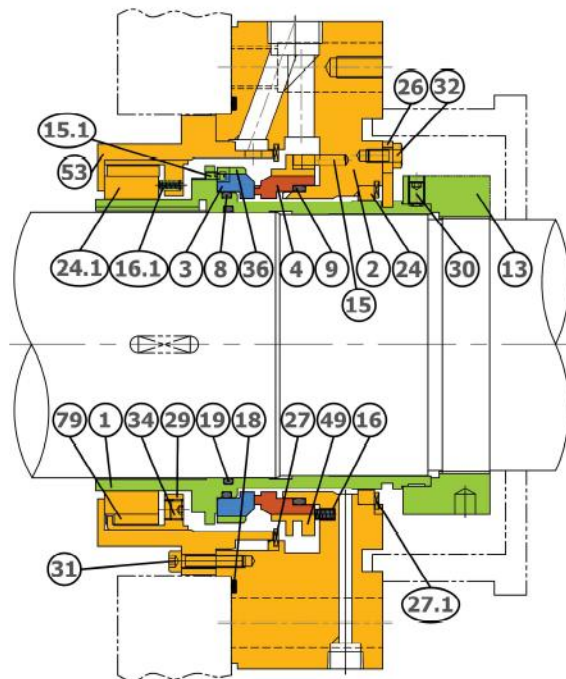

PN	PART
1	SLEEVE
2	GLAND RING
3	ROTATING FACE
4	STATIONARY FACE
8	ROTATING FACE O-RING
9	STATIONARY FACE O-RING
13	DRIVE COLLAR
15	LOCK PIN
15.1	LOCK PIN
16	SPRING
16.1	SPRING
18	GLAND O-RING
19	SLEEVE O-RING
24	FIXED THROTTLE BUSH
24.1	FLOATING THROTTLE BUSH
26	SETTING PLATE
27	SNAP RING
27.1	SNAP RING
29	BACKUP PLATE
30	SET SCREW
31	CAP SCREW
32	HEX. BOLT
34	PLUG
36	ROTATING FACE BODY
49	STATIONARY FACE BODY
53	HOUSING
79	THROTTLE BUSH BODY

Condensate extraction pumps (CEP) extract the condensate water from the condenser and pump it through the condensate polishing system and the LP heaters to the de-aerator feed water tank. In medium to large size gas-fired combined-cycle power plants, the CEP are vertical canned type to ensure enough Net Positive Suction Head Available (NPSHA). In small power plants, the CEP could also be horizontal end-suction type.

The condensate pumps are lower pressure pumps (~600 psig) designed to take suction from the low pressure condenser hotwell and deliver it to the main feedpumps. Several other pumps called Heater Drain pumps operate in parallel to assist in supplying the main feedpumps by pumping condensate from the feedwater heaters' drain tanks forward also.

For the sealing of feed pumps in power plants, mechanical seals have proven to be a reliable and cost effective sealing method compared to alternatives such as packing and throttle bushing seals with an injection of cold condensate. Mechanical seals achieve lifetimes of 40,000 hours or more in older power plants that historically use the All Volatile Water Treatment.

* Depending on material selected

All specifications, instrumentation and capabilities subject to change without notice

P/N: SSCEB-23

www.steinseal.in

POWER PLANT SEALS