

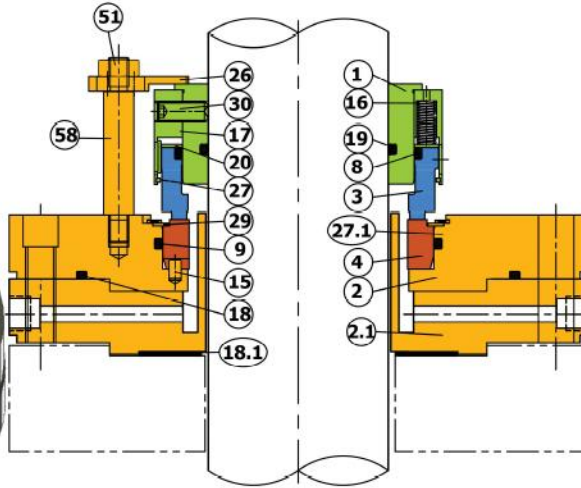

DRY RUNNING PHARMACEUTICAL MIXER SEAL

SSMXDS



PN	PART
1	SLEEVE
2	OUTER GLAND RING
2.1	INNER GLAND RING
3	ROTATING FACE
4	STATIONARY FACE
8	ROTATING FACE O-RING
9	STATIONARY FACE O-RING
15	LOCK PIN
16	SPRING
17	SPRING HOLDER
18	GLAND O-RING
18.1	GLAND GASKET
19	SLEEVE O-RING
20	RETAINING RING
27	SNAP RING
27.1	SNAP RING
29	BACKUP PLATE
30	SET SCREW
51	LOCK NUT
58	STUD

MATERIALS

- Hardware : 316 SS, 316L SS, Alloy C-276 & Alloy 20**
- Rotating face : Carbon**
- Stationary face : SiC & Aluminium Oxide**
- Elastomers : Buna-N, EPDM, Neoprene, FKM, FFKM**

OPERATING CONDITIONS

- Shaft : 25mm to 200mm**
- Pressure : Full Vacuum to 6 Bar**
- Temperature * : - 40°C ~ 149°C**
- Speed : Upto 1.5 m/s**

FEATURES AND BENEFITS

- Dry running contacting seal
- Single outside mounted balanced design
- Rotating multi-spring seal
- Flexible rotating face design
- Seal operates at eccentric run-out levels upto 3.81mm FIM.
- FDA grade materials
- Stationary face is double mounted o-ring prevents distortion
- Cartridge designs with or without bearing
- Cartridge design optional
- Sanitary gland for sterilization and steam cleaning debris
- No barrier fluid or gas required
- Designed for steel and glass lined vessels
- Clamping, shrink disc & set screw drive

RECOMMENDED APPLICATIONS / INDUSTRY

- Pharmaceutical
- Bio technology
- Fermentations
- Chemical
- Process
- Oil & gas
- Petrochemical
- Food & beverage
- Refinery

An single outside mounted dry running pharmaceutical mixer seal designed FDA grade materials specifically for use dead ended on Top-Entry Mixers in the pharmaceutical Industry.

* Depending on material selected

All specifications, instrumentation and capabilities subject to change without notice

P/N: SSMXDS-23

www.steinseal.in